

**INCLUDED**

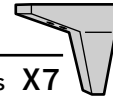

Woodscrews **X14**  
5mmX35mm

Wood Legs **X7**



**ATTENTION!** Chaise is directional and is available in right side or left side facing versions. Assembly is the same, but this chaise is NOT reversible.

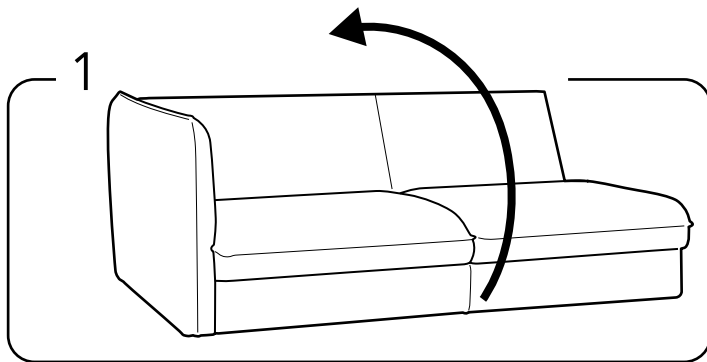

Turn the lovesofa to the backside.

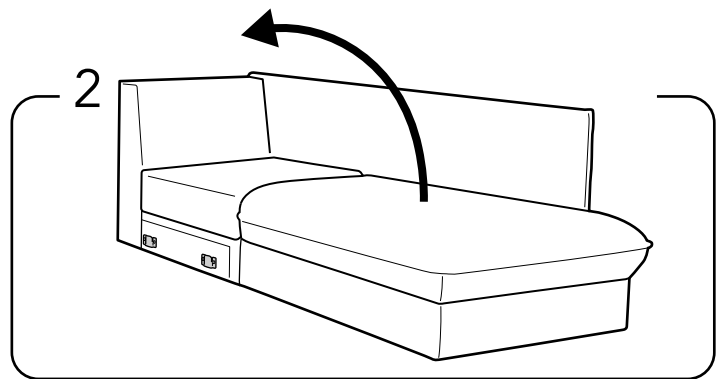

Turn the chaise to the backside.

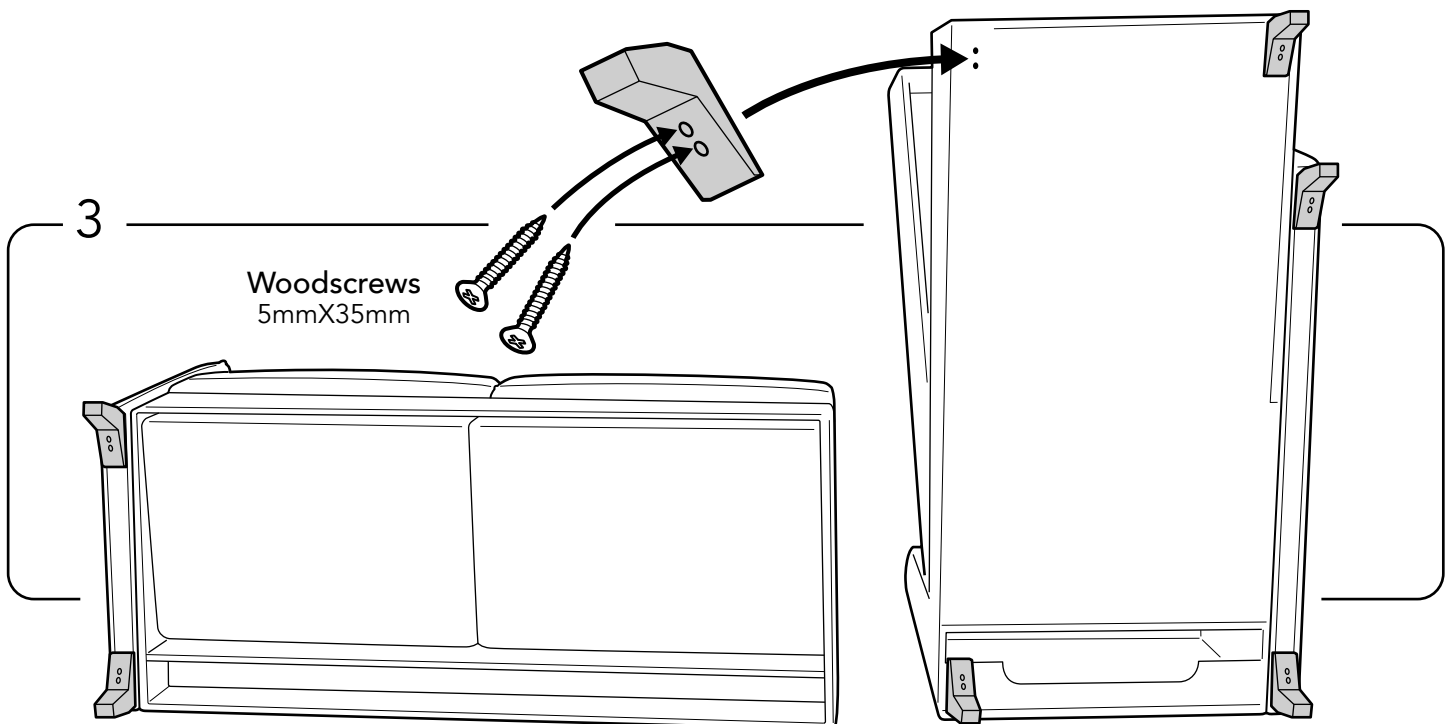

Attach each legs with the 2 (5mmX35mm) Woodscrews in the pre-drilled holes.

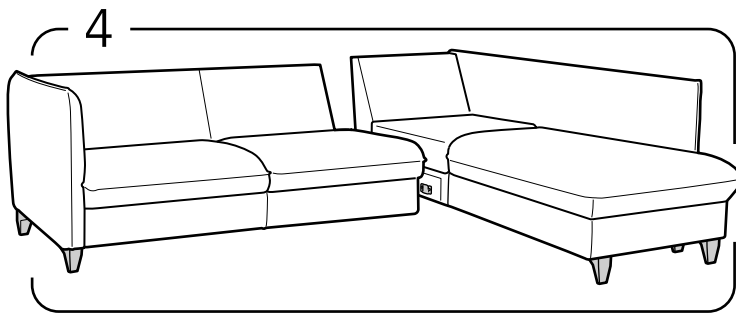

Turn the sofa and chaise back to the legs.

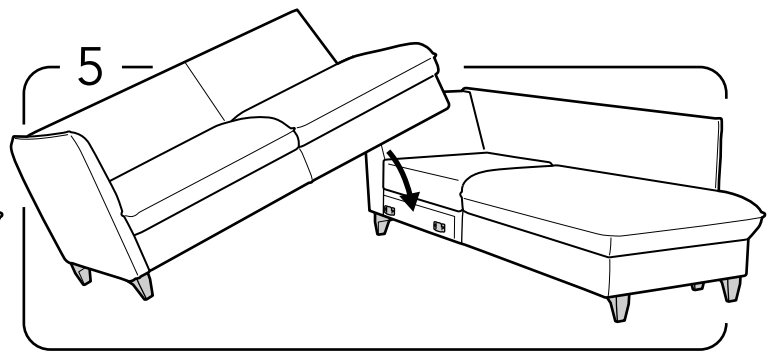

Attach the loveseat with the chaise part as shown on picture. Be sure that the both metal brackets are attached correctly!

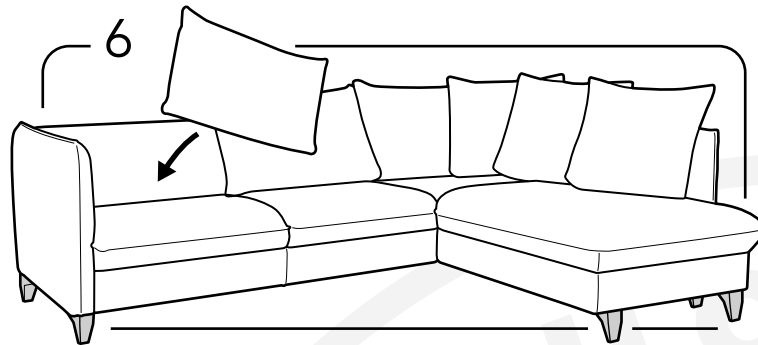

Insert the back cushion



This is what the final product should look like.