

# LUONTO®

## GRACE ASSEMBLY

Locating and installing the legs

### INCLUDED

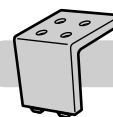

Metal Legs X4

Hex Wrenches X1



M6X25mm X16

### ATTENTION!

The Legs for your Luonto Sofa are secured to the top of the seat cushion or beneath the seat cushion (in the no-sag springs) depending on the sofa or leg style.

**2-Persons**  
are required



1

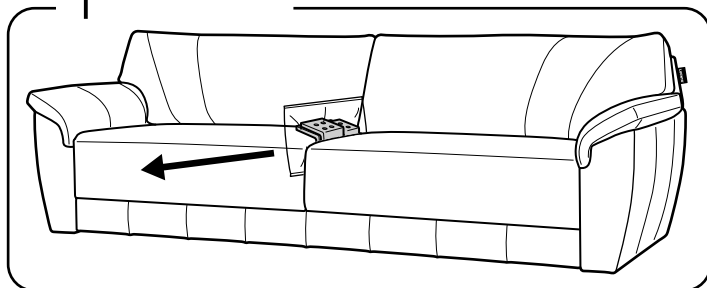

Remove the legs from the top of the seat cushion.

2

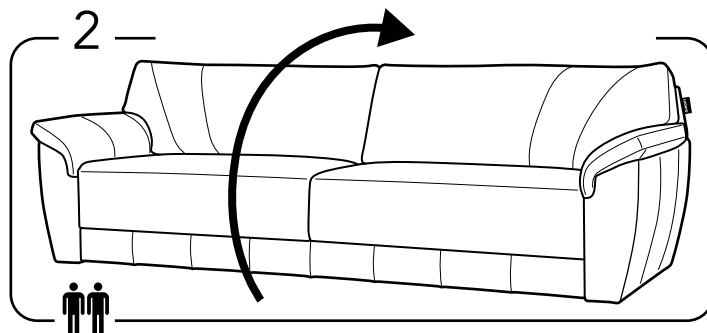

Turn the sofa to the backside.

3

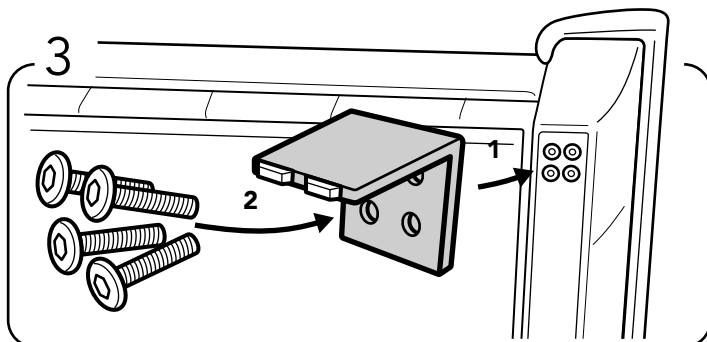

Mount the metal leg in place and screw the 2 (M6X25mm) bolts into the pre-drilled holes.

4

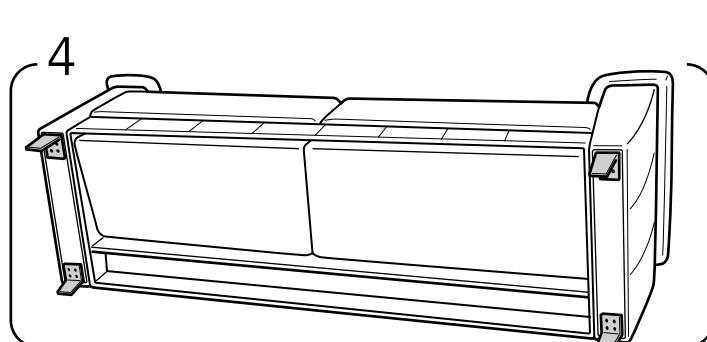

Repeat the same process for the 4 legs.

5

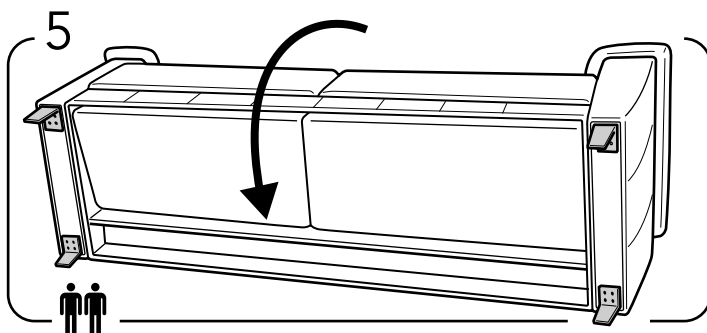

Carefully, turn the sofa upright and ensure each of the legs are installed properly.

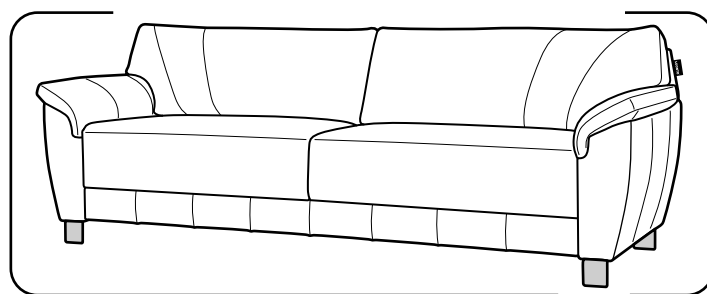

This is how the final product should look like

